

WALL FRAME BIG 27 mm

ITEMS DELIVERED

- 4 profile pieces
- 4 locks
- 1 allen key
- (wallmounts)
- (textile print with rubber lip all around)

YOU NEED ADDITIONALLY

- crosstip screwdriver
- (dowels)

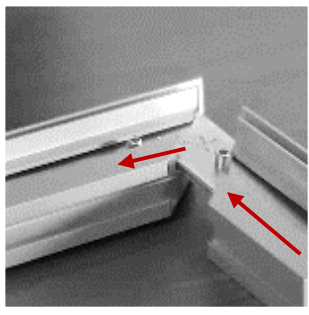
STEP 1

Connect corner

Take a profile piece and put the lock in the according rail in the profile. Put another profile piece on the lock. Connect 3 profile pieces in this way.

STEP 2

For frames ≥ 2 m: insert stabilizer

This could also be done after the frame mounting, but it is easier if only 3 profiles are connected. Prepare the stabilizers by inserting the locks in the stabilizer, so the holes of the lock and the stabilizer are above each other.

Now put the stabilizer in the frame while the lock is inserted in the inner slot of the profile. Then tighten the screws of the lock.

INSTRUCTIONS

STEP 3

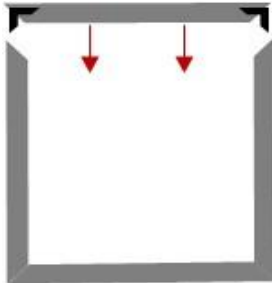

Connect all profiles and corners

Equip the last profile piece with the 2 left locks and put it on the 3 already mounted profiles.

STEP 4

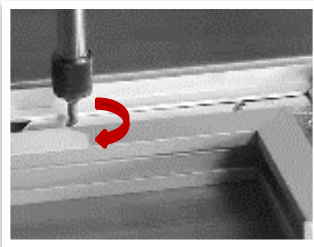

Tighten all locks and screws

Put the frame on an even ground and tighten all screws of the locks with the allen key.

STEP 5



Fix the frame to the wall

With wall mounts: Mount the wall mount with screws to the wall, so the frame can lie on it (angle edge to the top). You can adapt the frame height with the setscrew. Also fix the frame at the bottom and the sides with the angles if necessary.

Otherwise you drill holes in the profile and fix the frame with screws/dowels to the wall.

STEP 6

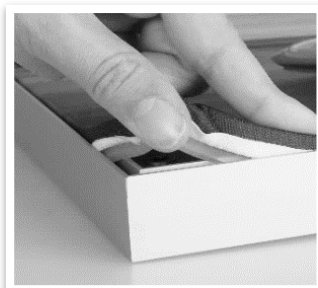

Insert textile

Insert the textile with the rubber lip into the according notch of the frame. Make sure that you hold the rubber lip right, since otherwise the textile will not fit in the frame: Fold the rubber lip slightly inwards (90°) and put it into the notch (see image).

Note regarding the wall mounting:

Depending on the wall conditions, different screws and dowels are necessary. Please check before mounting which mounting materials are suitable for you wall.