

CuttingTape



Knifeless Tape -3mm, 6mm, 12mm

-Cut film in any shape - without using a knife? Yes, you can!

It's inevitable. Sometimes film that has already been applied to a car or other substrate still needs to be cut to shape. This shouldn't present too many problems, should it? But is the cut uniform, neat, accurate and last but not least: has the knife damaged the substrate?

Is the car paintwork damaged?

Sadly, this happens all too often. When film is cut and the excess film is removed there is often a slight scratch mark left by the knife. This can cause enormous problems and above all can bring your expertise into question. Obviously, nobody cuts into a car's paintwork on purpose, however it

does happen. Accidents can easily be caused by a blunt knife, pressures of work or perhaps when using a film of a different thickness (e.g. laminated print film).

Not only that, but expert cutting takes time; you need a steady hand and a good sense of touch. Wouldn't it be great if you could make a perfect cut every time without damaging the substrate?



Cutting film when it's already on the car remains inevitable. Film must often be cut to a certain shape to follow the line of the grill, as shown in this photo. KnifelessTape is the answer. Damage to paintwork is eliminated and it's much faster.

Self-adhesive tape that cuts

KnifelessTape from Knifeless Tech Systems is the answer. This self-adhesive removable tape is equipped with a fine but very strong filament. This wire acts like a knife when you withdraw the filament from the tape it cut straight through the film. Now that's what you call innovation.

How does it work?

1

Apply the tape to where the film needs to be cut. Allow the tape to run 10cm past the finished film application line.

Apply the film as normal. Apply the film firmly until the edges of the KnifelessTape are visible through the applied film.

2

Now grasp the 10cm excess Knifeless Tape, pull the tape back on itself and lie the loosened tape along the remaining tape with the adhesive layer exposed. Place your thumb on the fold where the KnifelessTape is still stuck and snap the tape in such a way that the fine cutting filament appears through the tape.

3

Now pull the wire in the direction of the start of the film application while still holding your thumb on the edge of the film so that the filament can start the cut without the film becoming loose or damaged. This is best achieved with a quick firm tug in the direction of the film.

Now that the cutting filament is exposed through the first part of the film, simply pull the rest of the cutting filament through the remaining film. This should leave a perfect cut in the film.

Remove the excess tape from the side that needed cutting. Remove the remaining tape from beneath the film. The edges will probably appear slightly 'crinkled', however this is easily rectified: Just heat up the edges slightly with a heat gun and simply squeegee flat. Done!

1

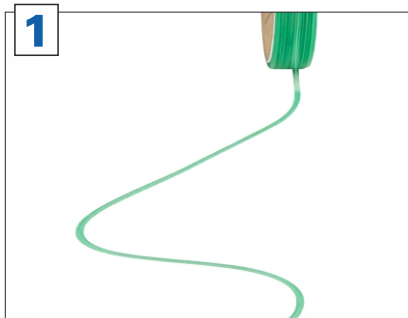

2

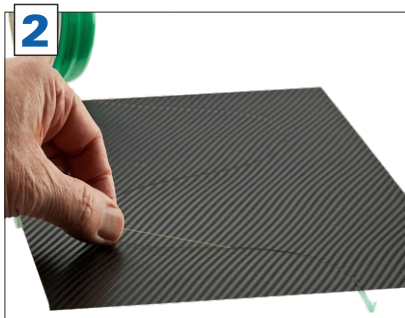

3



Use CuttingTape for:

- creating race panels on roofs and bonnets
- cut-outs for door handles, fuel caps and wing mirrors
- cutting door seams
- cutting race panels and striping to shape
- cutting for door rubbers
- cutting film to fit bonnet panels, etc

	350-206	Finish Line	3,5 mm width. Use for most wrap applications. Conformable around bumpers, doorhandles, mirrors, etc.	price per piece
	350-207	Bridge Line	12,7 mm width. For use between wide gaps like between doors, seams and rubber seals.	price per piece
	350-208	Design Line	Allows stretching, follows contours and turns easily in any direction. Excellent for creating designs & stripes with no extra steps required to achieve a perfect cut.	price per piece
	350-209	Perf Line	6,35 mm width. Use with perforated window film for perfect easy cuts every time. After trimmed leaves 3,2 mm gap to apply seal tape.	price per piece

