

EXCEL®

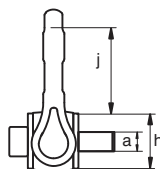

ADA

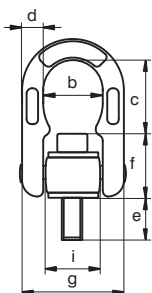

EXCEL® Rotating hoist ring, grade 8

- **Material** : alloy steel, grade 8, quenched and tempered
- **Safety factor** : MBL equals 5 x WLL
- **Finish** : painted red
- **Temperature Range** : up to +250°C
- **Certification** : 2.1 2.2 3.1 MPI^b CE
- **Note** : WLL indicated hereunder are given in the worst conditions of use, i.e. 90°

| working load limit | diameter thread | width inside | length inside | dia-meter | length | thick-ness base | width outside | dia-meter base | dia-meter base | length inside | Hex Key | Torque value | weight each |
|--------------------|-----------------|--------------|---------------|-----------|--------|-----------------|---------------|----------------|----------------|---------------|---------|--------------|-------------|
| t | a mm | b mm | c mm | d mm | e mm | f mm | g mm | h mm | i mm | j mm | mm | Nm | kg |
| 0.4 | M 8 x 1.25 | 35 | 41 | 13 | 18 | 35 | 68 | 34 | 38 | 43 | 6 | 6.5 | 0.43 |
| 0.7 | M10 x 1.5 | 35 | 39 | 13 | 18 | 37 | 68 | 34 | 38 | 43 | 8 | 13 | 0.44 |
| 1 | M12 x 1.75 | 35 | 36 | 13 | 22 | 39 | 68 | 34 | 38 | 43 | 10 | 22 | 0.46 |
| 1.3 | M14 x 2.0 | 35 | 35 | 13 | 22 | 42 | 68 | 34 | 38 | 43 | 12 | 35 | 0.47 |
| 1.6 | M16 x 2.0 | 35 | 42 | 13 | 28 | 43 | 68 | 34 | 38 | 52 | 14 | 55 | 0.52 |
| 2 | M18 x 2.5 | 35 | 40 | 13 | 28 | 45 | 68 | 34 | 38 | 52 | 14 | 80 | 0.54 |
| 2.5 | M20 x 2.5 | 35 | 38 | 13 | 32 | 47 | 68 | 34 | 38 | 52 | 17 | 110 | 0.59 |
| 3 | M22 x 2.5 | 53 | 57 | 20 | 33 | 69 | 105 | 49 | 56 | 71 | 17 | 150 | 1.88 |
| 4 | M24 x 3.0 | 53 | 55 | 20 | 39 | 71 | 105 | 49 | 56 | 71 | 19 | 190 | 1.93 |
| 5 | M27 x 3.0 | 53 | 61 | 20 | 45 | 65 | 105 | 49 | 56 | 71 | 19 | 280 | 1.96 |
| 6.3 | M30 x 3.5 | 53 | 61 | 20 | 45 | 65 | 105 | 49 | 56 | 71 | 19 | 380 | 2.03 |
| 7 | M33 x 3.5 | 71 | 87 | 30 | 54 | 83 | 146 | 68 | 77 | 98 | 19 | 520 | 5.28 |
| 10 | M36 x 4.0 | 71 | 87 | 30 | 54 | 84 | 146 | 68 | 77 | 98 | 19 | 600 | 5.35 |
| 10 | M39 x 4.0 | 71 | 87 | 30 | 63 | 84 | 146 | 68 | 77 | 98 | 19 | 870 | 5.45 |
| 12.5 | M42 x 4.5 | 71 | 87 | 30 | 63 | 84 | 146 | 68 | 77 | 98 | 19 | 1000 | 5.56 |

EXCEL®

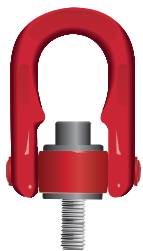

ADAUNC

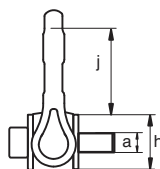
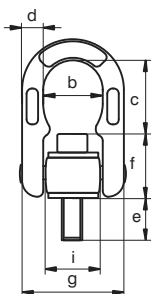

EXCEL® Rotating hoist ring UNC, grade 8

- **Material** : alloy steel, grade 8, quenched and tempered
- **Safety factor** : MBL equals 5 x WLL
- **Finish** : painted red
- **Temperature Range** : up to +250°C
- **Certification** : 2.1 2.2 3.1 MPI^b CE
- **Note** : WLL indicated hereunder are given in the worst conditions of use, i.e. 90°

| working load limit | diameter thread | width inside | length inside | dia-meter | length | thick-ness base | width outside | dia-meter base | dia-meter base | length inside | Hex Key | Torque value | weight each |
|--------------------|---------------------------------------|--------------|---------------|-----------|--------|-----------------|---------------|----------------|----------------|---------------|---------|--------------|-------------|
| t | a inch | b mm | c mm | d mm | e mm | f mm | g mm | h mm | i mm | j mm | mm | Nm | kg |
| 0.4 | ⁵ / ₁₆ - 18 UNC | 35 | 41 | 13 | 18 | 35 | 68 | 34 | 38 | 43 | 6 | 6.5 | 0.43 |
| 0.6 | ³ / ₈ - 16 UNC | 35 | 39 | 13 | 18 | 37 | 68 | 34 | 38 | 43 | 8 | 13 | 0.44 |
| 1 | ¹ / ₂ - 13 UNC | 35 | 36 | 13 | 24 | 39 | 68 | 34 | 38 | 43 | 10 | 22 | 0.46 |
| 1.7 | ⁵ / ₈ - 11 UNC | 35 | 42 | 13 | 31 | 43 | 68 | 34 | 38 | 52 | 13 | 55 | 0.54 |
| 2.5 | ³ / ₄ - 10 UNC | 35 | 38 | 13 | 31 | 47 | 68 | 34 | 38 | 52 | 16 | 110 | 0.55 |
| 3.5 | ⁷ / ₈ - 9 UNC | 53 | 57 | 20 | 37 | 69 | 105 | 49 | 56 | 71 | 19 | 150 | 1.88 |
| 4.5 | 1 - 8 UNC | 53 | 55 | 20 | 43 | 71 | 105 | 49 | 56 | 71 | 19 | 190 | 1.93 |

EXCEL® Rotating hoist ring longer length, grade 8

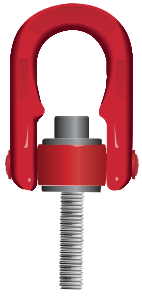

ADAL

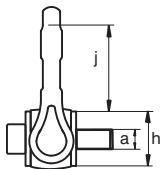
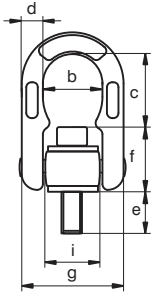

- **Material** : alloy steel, grade 8, quenched and tempered
- **Safety factor** : MBL equals 5 x WLL
- **Finish** : painted red
- **Temperature Range** : up to +250°C
- **Certification** : **2.1 2.2 3.1 MPI b CE**
- **Note** : WLL indicated hereunder are given in the worst conditions of use, i.e. 90°

| working load limit | diameter thread | width inside | length inside | dia- meter | length | thick- ness base | width outside | dia- meter base | dia- meter base | length inside | Hex Key | Torque value | weight each |
|--------------------|-----------------|--------------|---------------|------------|--------|------------------|---------------|-----------------|-----------------|---------------|---------|--------------|-------------|
| t | a mm | b mm | c mm | d mm | e mm | f mm | g mm | h mm | i mm | j mm | mm | Nm | kg |
| 0.4 | M 8 x 1.25 | 35 | 41 | 13 | 52 | 35 | 68 | 34 | 38 | 43 | 6 | 6.5 | 0.46 |
| 0.4 | M 8 x 1.25 | 35 | 41 | 13 | 92 | 35 | 68 | 34 | 38 | 43 | 6 | 6.5 | 0.47 |
| 0.7 | M10 x 1.5 | 35 | 39 | 13 | 62 | 37 | 68 | 34 | 38 | 43 | 8 | 13 | 0.47 |
| 0.7 | M10 x 1.5 | 35 | 39 | 13 | 125 | 37 | 68 | 34 | 38 | 43 | 8 | 13 | 0.5 |
| 1 | M12 x 1.75 | 35 | 36 | 13 | 62 | 39 | 68 | 34 | 38 | 43 | 10 | 22 | 0.49 |
| 1 | M12 x 1.75 | 35 | 36 | 13 | 125 | 39 | 68 | 34 | 38 | 43 | 10 | 22 | 0.53 |
| 1.6 | M16 x 2.0 | 35 | 42 | 13 | 92 | 43 | 68 | 34 | 38 | 52 | 14 | 55 | 0.6 |
| 1.6 | M16 x 2.0 | 35 | 42 | 13 | 172 | 43 | 68 | 34 | 38 | 52 | 14 | 55 | 0.71 |
| 2.5 | M20 x 2.5 | 35 | 38 | 13 | 112 | 47 | 68 | 34 | 38 | 52 | 17 | 110 | 0.75 |
| 2.5 | M20 x 2.5 | 35 | 38 | 13 | 172 | 47 | 68 | 34 | 38 | 52 | 17 | 110 | 0.87 |
| 4 | M24 x 3.0 | 53 | 55 | 20 | 112 | 71 | 105 | 49 | 56 | 71 | 19 | 190 | 2.16 |
| 4 | M24 x 3.0 | 53 | 55 | 20 | 172 | 71 | 105 | 49 | 56 | 71 | 19 | 190 | 2.33 |
| 5 | M27 x 3.0 | 53 | 61 | 20 | 90 | 65 | 105 | 49 | 56 | 71 | 19 | 280 | 2.2 |
| 6.3 | M30 x 3.5 | 53 | 61 | 20 | 90 | 65 | 105 | 49 | 56 | 71 | 19 | 380 | 2.27 |
| 6.3 | M30 x 3.5 | 53 | 61 | 20 | 240 | 65 | 105 | 49 | 56 | 71 | 19 | 380 | 3.05 |
| 10 | M36 x 4.0 | 71 | 87 | 30 | 110 | 84 | 146 | 68 | 77 | 98 | 19 | 600 | 5.72 |
| 12.5 | M42 x 4.5 | 71 | 87 | 30 | 120 | 84 | 146 | 68 | 77 | 98 | 19 | 1000 | 6.07 |