



RIV 4600

Ball valve with compression ends
 for copper pipe
 full bore
 red steel lever handle

Tech drawings and tables

DN	Code	Ø	H	S	L	B	KG	P/box
15	024600000035	14,5	48	55	80	71	0,217	10
22	024600000041	19	55	65,5	105	83,5	0,351	10
28	024600000026	24	60	71	105	91	0,500	10

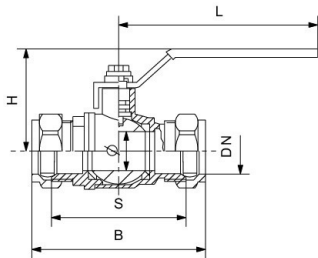

Technical data

Art. 4170

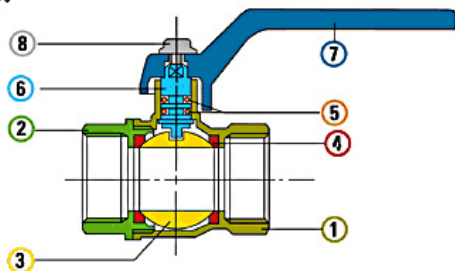

Materials

1	Body	Brass	CW617N	Nickel-plated
2	Body end	Brass	CW617N	Nickel-plated
3	Ball	Brass	CW617N	Chrome-plated
4	Seats	P.T.F.E.		
5	O-Ring	NBR		
6	Stem	Brass	CW614N	
7	Lever	Aluminium		Red
8	Screw	Steel		Zinc-plated

Connections

ISO 228/1, ANSI B1.20.1 (NPT)

Limit

-20°C (without liquid) +110°C

Notes

The max.working pressure (PN) means at a room temperature of about 23°C.

Pressure Loss Chart

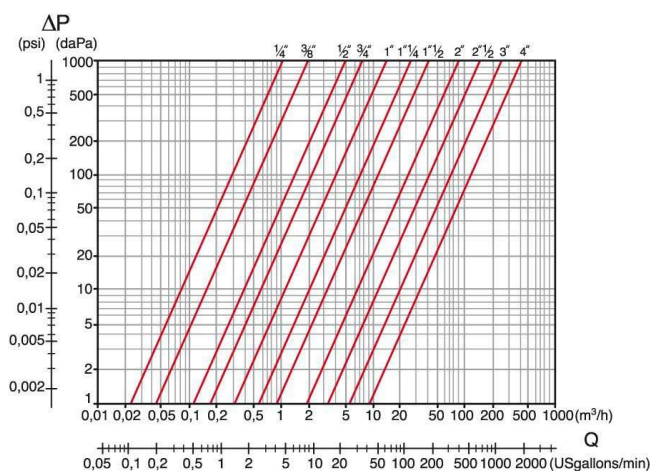

Temperature/Pressure

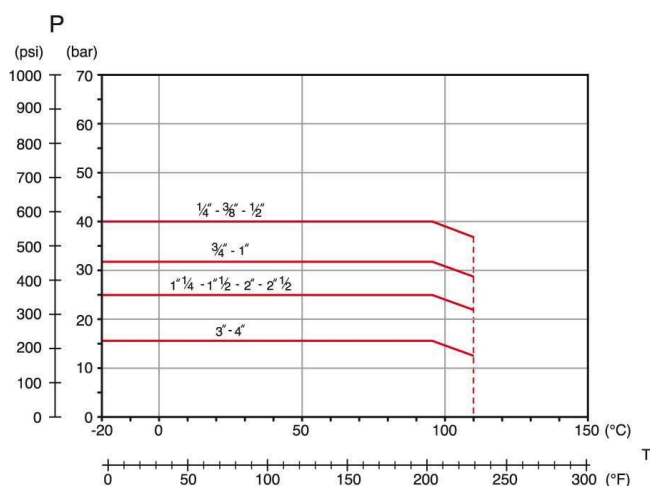

Kv & Cv Coefficients

Size	Kv	Cv
1/4"	3,6	4,2
3/8"	6,6	76,0
1/2"	16,5	19,1
3/4"	25,0	29,0
1"	46,0	53,0
1"1/4	87,0	101,0
1"1/2	140,0	162,0
2"	275,0	318,0
2"1/2	500,0	578,0
3"	850,0	983,0
4"	1350,0	1562,0

Approvals



RIV Rubinetterie Italiane Velatta S.p.A. - Via delle Acacie, 8 Zona Industriale D4 - 28075 GRIGNASCO (NO) - ITALY
Tel +39 0163 4151 Fax +39 0163 411914 E-mail riv-vg@riv-vg.com Web www.riv-vg.com

Capitale sociale € 516.000 i.v. - Reg. Imprese di Novara N° 00469610026 - R.E.A. di Novara N° 170397
Numero Meccanografico NO009263 - Codice Fiscale: 00469610026 - Partita IVA: IT 01399720034

