

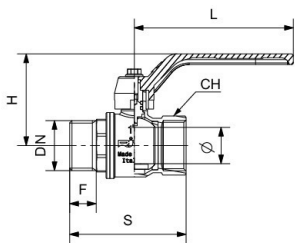

RIV 4330

Ball valve M/F
 full bore
 aluminium lever handle

Tech drawings and tables



DN	Code	Ø	H	S	L	F	PN	KG	P/box
1/4"	024330000002	8	46	45	80	10,5	40	0,099	50
3/8"	024330000003	10	48	48	80	10,5	40	0,121	50
1/2"	024330000004	14,5	50	55	80	13	40	0,151	30
3/4"	024330000005	19	57	65	105	14	32	0,263	10
1"	024330000007	24	60	77	105	17	32	0,385	10
1"1/4	024330000008	30,5	73	87	120	17	25	0,630	8
1"1/2	024330000009	37	86	101	135	19	25	0,890	6
2"	024330000011	47	98	117	160	21	25	1,434	4
2"1/2	024330000013	60	110	136	160	30	25	2,103	1
3"	024330000014	75	148	157	265	33	16	3,527	1
4"	024330000016	94	163	189	265	40	16	6,096	1

Technical data

Art. 4170

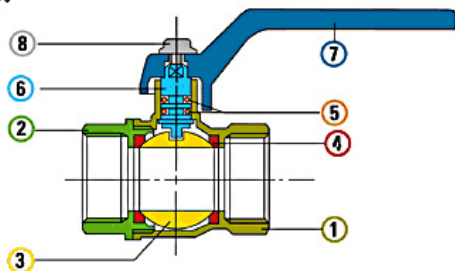

Materials

1	Body	Brass	CW617N	Nickel-plated
2	Body end	Brass	CW617N	Nickel-plated
3	Ball	Brass	CW617N	Chrome-plated
4	Seats	P.T.F.E.		
5	O-Ring	NBR		
6	Stem	Brass	CW614N	
7	Lever	Aluminium		Red
8	Screw	Steel		Zinc-plated

Connections

ISO 228/1, ANSI B1.20.1 (NPT)

Limit

-20°C (without liquid) +110°C

Notes

The max.working pressure (PN) means at a room temperature of about 23°C.

Pressure Loss Chart

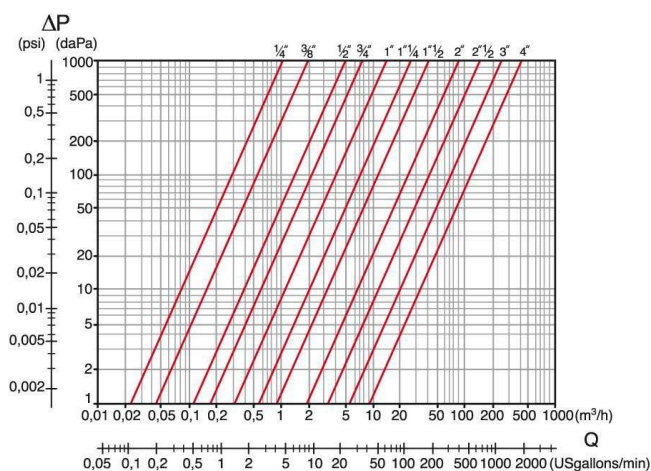

Temperature/Pressure

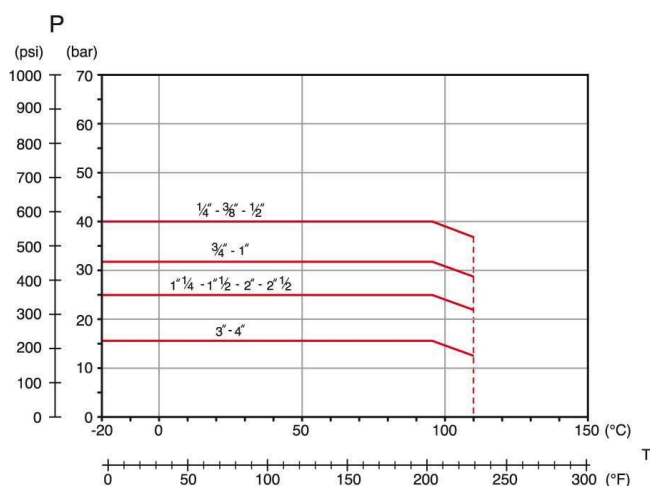

Kv & Cv Coefficients

Size	Kv	Cv
1/4"	3,6	4,2
3/8"	6,6	76,0
1/2"	16,5	19,1
3/4"	25,0	29,0
1"	46,0	53,0
1 1/4"	87,0	101,0
1 1/2"	140,0	162,0
2"	275,0	318,0
2 1/2"	500,0	578,0
3"	850,0	983,0
4"	1350,0	1562,0

Approvals



RIV Rubinetterie Italiane Velatta S.p.A. - Via delle Acacie, 8 Zona Industriale D4 - 28075 GRIGNASCO (NO) - ITALY
Tel +39 0163 4151 Fax +39 0163 411914 E-mail riv-vg@riv-vg.com Web www.riv-vg.com

Capitale sociale € 516.000 i.v. - Reg. Imprese di Novara N° 00469610026 - R.E.A. di Novara N° 170397
Numero Meccanografico NO009263 - Codice Fiscale: 00469610026 - Partita IVA: IT 01399720034

