

D Series Knob Panel



D61



1. Technical Specs:

D61 Dimming Knob Panel

Input Voltage:	12~24Vdc	Dimming Range:	5~100%
Output Voltage:	12~24Vdc	Working Temp.:	-30°C~55°C
Max Current Load:	6A×1CH + 0-10V×1CH	Package Size:	L106×W106×H60(mm)
Max Output Power:	72W/144W (12V/24V)	Weight(G.W.):	220g

2. Product Size:

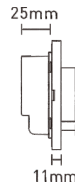
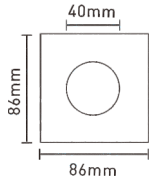

3. Installation Instruction:

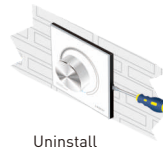
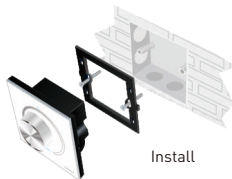

4. Knob Function:



Short press: On/Off.
Long press: Adjust brightness.
Spin: Adjust brightness.

* When powered off, long press the knob for 5 seconds to turn on (off) the key tone.

5. Terminals:

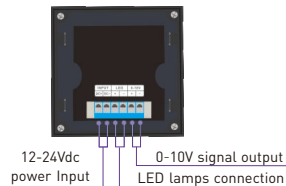

6. Wiring Diagram :

Connect with 12V strip. Max 72W; Connect with 24V strip. Max 144W

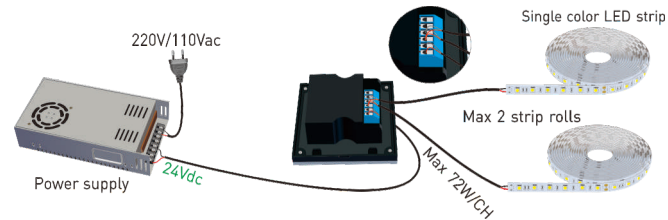

Providing 0-10V signal output terminal:

