

# Mounts for screens and laptops



Safety  
Flexibility  
Ergonomics



Product catalogue Zirkona Sweden

## Joined by Zirkona.

In 1995 we began thinking about mounting screens and laptops in vehicles. Sure, we were ahead of our time since the demand wasn't huge but still it was our firm belief that mobile offices would be the future.

A lot has happened since 1995 and above all, the technological developments have been enormous. Today almost every truck, commercial vehicle and car is equipped with some kind of screen or computer. Both large and small companies see the benefits of being able to work on the go and as the technologies improve, we are confident that we have only seen the start of a growing demand.

When our mounts become part of the daily work the demands for function and quality are high, which inspire us and drives our product development. We always strive to help our customers create secure, flexible and ergonomic workplaces wherever the need exists.

Our product line consists of stands customized for a specific use and the component system Zirkona Joiner System, both created for mounting screens and laptops, TV, e-readers etc. The possibilities are endless and the limitations are few. In motor homes, caravans, homes, offices, industries, hospital environments etc. the Zirkona Joiner System can be used to create flexible mounts for screens and laptops.

Join us!



Martin Ericsson  
CEO  
Zirkona Sweden AB





# Mounts for screens and laptops

## The efficient mobile office

With new technology and ever increasing opportunities to work in a mobile office there are no longer order blocks or files to be picked up and dropped during a working day. There is more to gain by being able to manage reporting, placing orders, invoicing etc. while being on the go.

The opportunities to make both small and large companies more effective are huge. A mobile office requires a laptop or screen where it is important that these can be handled in an efficient and hassle free manner.

With a stand from Zirkona Sweden, the user quickly and easily develop their vehicle into a mobile office and can therefore help businesses become more efficient and profitable.

## The modern mobile office

Zirkona Sweden focuses, the modern mobile office, on flexibility, safety and ergonomics. The stands are available as ready-made solutions but also in the component system Zirkona Joiner Systems where solutions are put together based on each customer's unique needs.

Based on each vehicle model conditions the stands are fixed to create the best possible workplace. Zirkonas products attach both laptops screens and tablet devices and the unique flexibility makes the stands easy to quickly adapt to a mobile workplace, in your car, boat, motorhome, etc.

# Ergonomics

## An ergonomic workplace

Mobile working can save a lot of time and improve profitability.





But if the work is done in an improper ergonomic position, the long-term effect will be increased costs and reduced profitability due to sick staff. It is therefore important that the mobile working staff are given the right working conditions needed to carry out the work in the best way.

Stands from Zirkona Sweden are easily adjusted to give the driver right working conditions. The unique flexibility makes it possible to quickly adapt the workplace so that the driver has an ergonomically correct working position.



# Safety

## Vehicle safety - loose objects in the mobile office

One collision - three phases			
Phase 1	Vehicle collision	Vehicles are designed to break without affecting the driver's area.	
Phase 2	The human collision	The body continues in the vehicle's direction.	
Phase 3	The internal collision	The internal organs continue in the body's direction.	
The modern mobile office adds risks in a collision.			
Phase 4	Loose objects	Loose objects moving around inside the vehicle involves a significant risk of personal injury.	
Travelling with loose objects in the vehicle therefore entails a high risk of injury. The following table shows what common object weighs at a collision.			
Item	Normal weight	50 km/h	100 km/h
iPad	600 g	24 kg	96 kg
PC 10"	600 g	24 kg	96 kg
PC 15"	2200 g	88 kg	352 kg
Tough book 14"	4000 g	100 kg	640 kg

# Products

Zirkona Sweden's stands are adapted for use in vehicles. The stands creates a secure, ergonomic and flexible workplace whether the need is to mount a screen or a laptop.

All Zirkona stands are made out of durable materials and developed to function flawlessly in vehicle environments. Where there is a need for a quick and easy removal of the stand from the vehicle we recommended Zirkona ZiOne, Hook and Seat Holder, all installed without screws. Mounting position for the other stands vary depending on use.

The stands flexibility is achieved through the integration of the unique ball joint Zirkona Joiner which makes it easy to adjust the stand for every drivers needs. Stands sold without computer bracket or screen bracket are supplemented as needed.



## 401690 Zirkona ZiOne



Mounted on the window with a suction cup. Flexible telescopic arm. A convenient solution for those who want their notebook / PC on the go. Easily removed and can be moved between cars. Fits 8-13" (210-300 mm) notebook / PC /Tough screens.

## 401810 Zirkona Backwall Standard



Laptop stand for mounting on the backwall in commercial vehicles. You fold down the computer when you use it and fold it away when driving. The arm is locked in upright position.



## 401820 Zirkona Backwall Telescop



Laptop stand with with telescopic function for mounting on the back wall in commercial vehicles. You fold down the computer when you use it and fold it away when driving. The arm is locked in upright position.







Zirkona Backwall



Zirkona Hook



In Dash



Zirkona ZiOne



Zirkona Shelf

#### 402210 Zirkona Telescopic Stand



##### Accessories



208000

Telescopic function with ball joints makes it possible to lower the stand to the floor when not in use. Computer Bracket Hold Large 280-400 mm included. With accessory 208000 this Stand is mounted in the seat rail. Accessories for other attachment points can be selected from Zirkona Joiner System.

#### 402410 Zirkona Hook



Laptop holder that is hung on the steering wheel. A quick and easy way to create an ergonomic workplace in your vehicle. Can be folded to fit into a standard laptop bag.

#### 402515 Zirkona SeatHolder



##### Accessories



501100



601020



601040

Stand for mounting on passenger seat. Fits most vehicles. Is supplemented with appropriate ball joint and computer or screen bracket.

# continued from previous page...

## 401719 Zirkona Robust

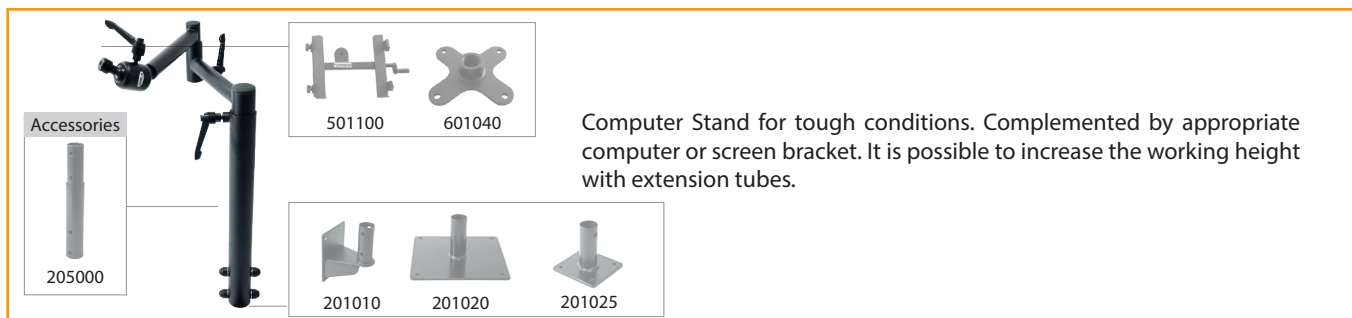

Accessories

205000

501100 601040

201010 201020 201025

Computer Stand for tough conditions. Complemented by appropriate computer or screen bracket. It is possible to increase the working height with extension tubes.

## 201040 Zirkona Dashboard mount

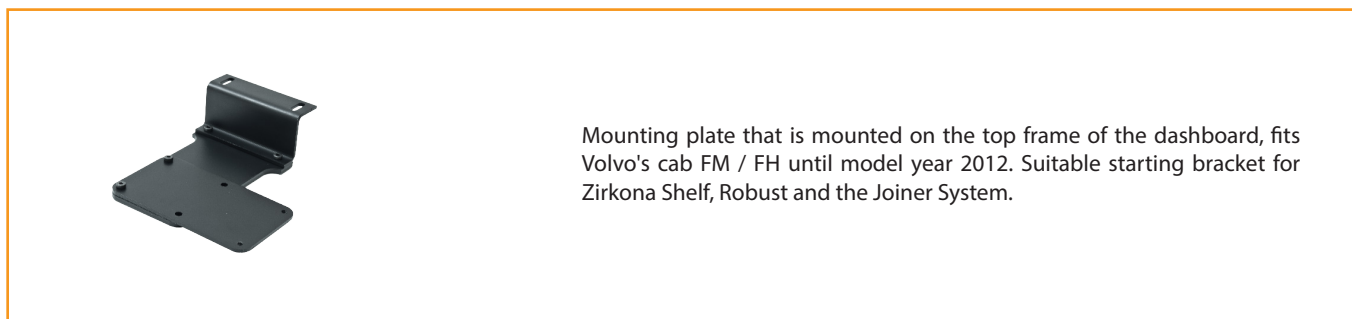

Mounting plate that is mounted on the top frame of the dashboard, fits Volvo's cab FM / FH until model year 2012. Suitable starting bracket for Zirkona Shelf, Robust and the Joiner System.

## 201041 Zirkona Dashboard mount



Mounting plate that is mounted on the top frame of the dashboard, fits Volvo's new cab FM / FH from model year 2012. Suitable starting bracket for Zirkona Shelf, Robust and the Joiner System.





### 701010 Zirkona In Dash

Accessories

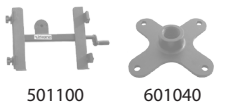

Stand for mounting through dash board in trucks. Is supplemented with appropriate computer or screen bracket.

### 702001 Zirkona DIN



Stand for mounting in vehicle's DIN compartment. VESA 75 is included. The bracket is mounted in the DIN slot and screwed into the rail behind. Fits in most vehicles. A stable and easily mount for screens. Handles up to 3 kg.

### 702003 Zirkona dubbel DIN



Stand for mounting in the double DIN compartment of trucks. Suitable for Scania. Installed in existing double DIN box.

### 702110 Zirkona Shelf

Accessories



Stand for mounting on centre console in trucks. Stabilizer included. Is supplemented with appropriate computer or screen bracket.

## Accessories

The accessories to Zirkona stands should be seen as suggestions. All stand are compatible with Zirkona Joiner System and can therefore be adapted to every need.

Contact your retailer for help regarding what accessories completes your stand in the best way.

For inspiration and mounting suggestions visit [www.zirkona.com](http://www.zirkona.com)

# Zirkona Telescopic Stand

art. No 402210



## Note!

Loctite

Always apply thread lockers on 20 mm threads. Use Loctite or equivalent.



1.

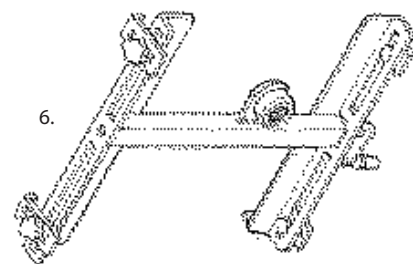
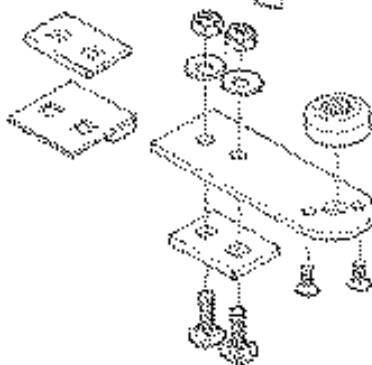

6.

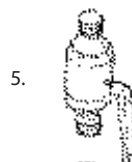

5.



4.

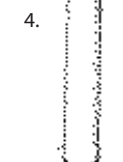

3.



2.



## Zirkona Telescopic Stand

1. The installation is done on the passenger side.
2. Mount the seat rail bracket by choosing appropriate seizure, depending on how the seat rail is designed.
3. Attach Joiner Large (601030) to the seat rail bracket.
4. Attach the telescopic tube to Joiner Large (601030). Screw the support bracket at a suitable location.
5. Attach Joiner Medium (601020) to the telescopic tube.
6. Attach Computer Bracket Hold Large (501100) to Joiner Medium (601020), then tilt the Computer Bracket Hold Large to appropriate position.

# Zirkona Backwall Telescop

art. No 401820



## Note!

Loctite

Always apply thread lockers on 20 mm threads. Use Loctite or equivalent.

## Zirkona Backwall

Mount the wall brackets (A) to the Backwall bracket according to the picture.

Use included carriage bolts, washers and locking nuts. Please observe that the screw-nuts must be placed inside the bracket, see picture. The upper bracket can be placed inside the bracket, see picture. The upper bracket can be placed in two positions. For vehicles with a steeply leaning back wall there is an optional longer wall bracket (B) included.

Position the bracket against the vehicle back wall. Make sure that the bracket can be folded up and down without colliding with the interior and that the computer is at a good ergonomical position when folded down. We recommend a distance of 18 cm from the center of the seat.

*Please note that the bracket must be mounted vertically.*

The Backwall bracket is to be mounted with the 8 mm carriage bolts supplied, washers and locking screw-nuts through the vehicle back wall. Use supplied stabilizing plates. Avoid possible damage to wires, pipes etc. when drilling through the back wall.

Fine adjustments of the computer position can be made through the oval holes in the wall bracket as well as by adjusting the set screw.

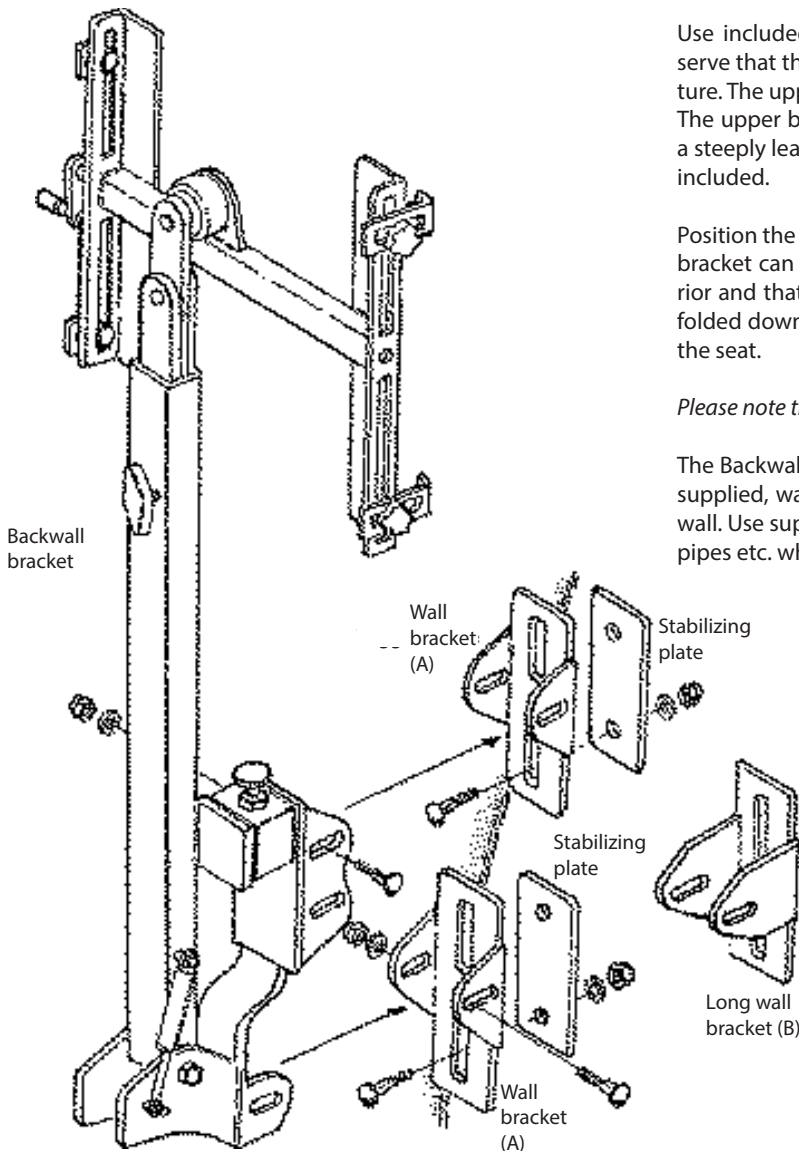

# Zirkona Robust

art. No 401719



## Note!



Always apply thread lockers on 20 mm threads. Use Loctite or equivalent.

## Zirkona Robust

Install start bracket (floor bracket art. No 201020 or Side bracket art. No 201020) in the desired place with suitable screws (not included).

Attach the outer tube on the start bracket tube; lock it in place with 2 M8 x 50 bolts and screw-nuts (included).

Place the complete arm system into the outer tube; attach the computer holder or screen bracket.

When increased work height is needed install extension tube art. No 205000 on start bracket with 2 M8 x 50 bolts and screw-nuts (not included).

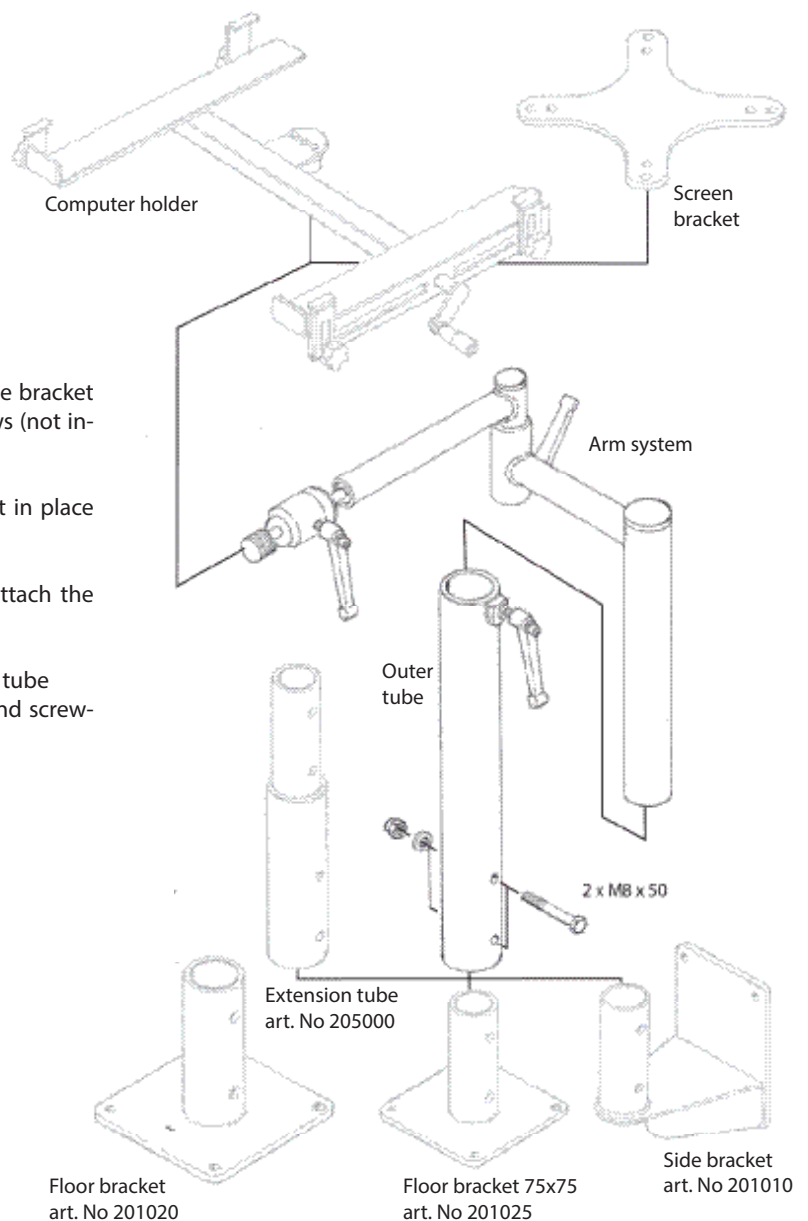



# Zirkona Shelf

art. No 702110



**Note!** 

Always apply thread lockers on 20 mm threads. Use Loctite or equivalent.

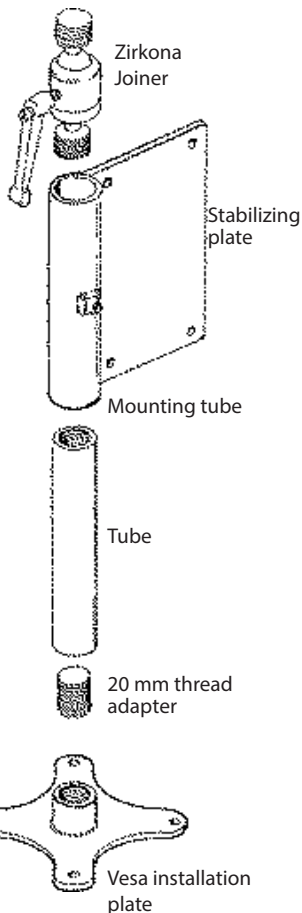

**Zirkona Shelf**

Installation is done on the shelf in front of the central console.

Remove the rubber mat from the shelf and place the Vesa 75 installation plate (when installing in the new Scania cabin the Vesa 75 installation plate should be mounted in the lidded storage compartment, and two of the wings of the plate need to be filed down slightly). Attach the 20 mm thread adapter to the Vesa 75 installation plate and then mount the tube.

Thread the stabilizing plate over the tube so that the plate fits against the instrument panel. (In Scania the stabilizing plate is normally installed behind the coffee maker.) Attach locking screws on the tube to the stabilizing plate once the installation is made. Then drill four 6 mm holes in the console to attach the stabilizing plate using M6 bolts, washers and locknuts.

When the Vesa 75 installation plate is fixed in place, drill four holes in the shelf and attach the Vesa 75 installation plate with four bolts, washers and locknuts. (In the new Scania cabin the installation plate should be mounted in the lidded storage compartment, with selfdrilling sheet metal screws. Screws not supplied.)

Cut a hole for the mounting tube of the Vesa installation plate in the rubber mat and replace the mat. (In the new Scania cabin the lid can be removed or left in place but if left in place must have a hole cut into it to close.)

Install the Zirkona Joiner. Mount the installation plate onto the Zirkona Joiner and install the computer holder.

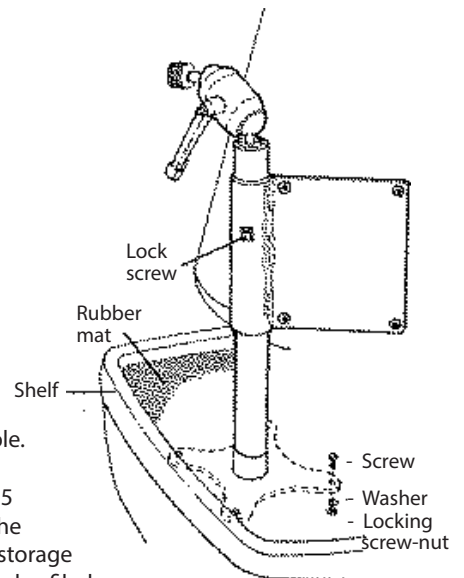

# Joiner System

Zirkona Joiner System provides endless opportunities to assemble flexible and stable mounts for laptops, screens and TVs.

The components are made out of durable aluminum and are vibration tested to ensure flawless performance even in the toughest of environments.

Based on need, appropriate components are assembled to mounts suitable for both cars, trucks, recreation vehicles, homes, offices, industries, etc. The unique flexibility of the ball joint ensures that the mount can be adjusted to an ergonomic working position.

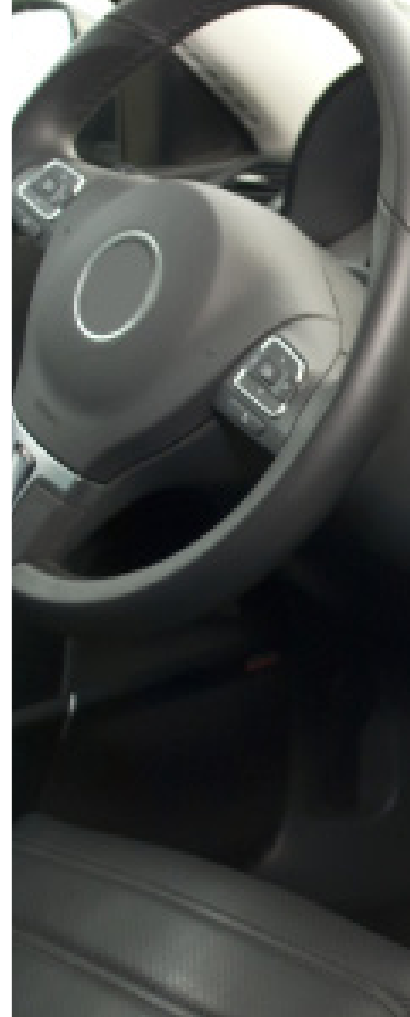

## Customize your mount - easy as it gets





We have tried to make it easier for you to choose a mounting solution from the Joiner System. Follow the schedule below and you will have a Joiner system that suits you.

- 1 **Select screen**, e.g. touch screen, tablet PC, notebook, laptop, rearview camera, TV, LCD-screen etc.
- 2 **Select appropriate mount for your screen**
- 3 **Select Zirkona Joiner**
- 4 **Select extension**
- 5 **Select end bracket**

1

Select screen, e.g. touch screen, tablet PC, notebook, laptop, rearview camera, TV, LCD-screen etc.

2

Select appropriate mount for your screen

**501100**  
Bracket Hold Large



Fits all laptops 13-17" (280-400mm). The computer is stabilized from the sides by use of a crank. Adjustable side brackets for access of power cable and USB etc.

**501200**  
Bracket Hold Small



Fits all laptops 8-13" (210-300mm). The computer is stabilized from the sides by use of a crank. Adjustable side brackets for access of power cable and USB etc.

**503000**  
Screen Keyboardplate



Is used for an easy way to fix both the screen and keyboard in the truck or other similar vehicle.

**ZI 501400**  
Screen Holder



Passar till läsplattor....  
.....  
.....  
.....

**601100**  
Joiner Quicker



Fitted to the windowpane, windshield or other flat surfaces.

**601040**  
Joiner Vesa 75



For mounting of most screens, tablet PCs, smaller TV or similar products. Can also be used for mounting on the instrument panels, floor or ceiling.

**601042**  
Joiner Vesa 75/100



For installation on most large monitors, PCs, TVs or similar. Can also be used for mounting on the instrument panels, floor or ceiling.

**601044**  
Joiner Diamond Plate



Fits on already existing screens. Can also be mounted on their own selected anchor points.

**601065**  
Round Mounting Plate



Hole pattern 38x38 mm. Plate with threaded holes. Attaches to existing anchor points.

**601060**  
Round Mounting Plate



Hole pattern 2+2+3, for mounting on instrument panels, walls and ceilings.



## 3 Select Zirkona Joiner

**601010**  
Joiner Small



For mounting of smaller screens, cameras or similar. Suitable for mounting products that needs to hang in the air and to be adjustable.  
Maximum 2.5 kg.

**601020**  
Joiner Medium



For installation of laptops, screens, TV or similar. Variable, easily adjustable in 360 degrees with 135 degrees downfold. Can handle weights up to 15 kg standstill. The variable positions where vibrations occur, vehicle type, max 5,5 kg.

**601030**  
Joiner Large



For installation of large laptops, PC, TV screens or similar. Variable, easily adjustable in 360 degrees with 135 degrees downfold. Can handle weights up to 25 kg standstill. The variable positions where vibrations occur, vehicle type, max 9 kg.

proceed directly to step 5 if you do not choose an extension

## 4 Select extension

**601059**  
Joiner Telescopic arm



235-400 mm.  
Smart extension attached with other Zirkona Joiner products.

**Joiner Sleeve**  
50-300 mm



Article No

50 mm:	art. No 601051
100 mm:	art. No 601052
150 mm:	art. No 601053
200 mm:	art. No 601056
300 mm:	art. No 601054

Available in five lengths, 50, 100, 150, 200 and 300 mm.  
Can be paired with each other, (with Zirkona Joiner M20 Adapter) in order to get the best mounting solution.

**601082**  
Joiner Sleeve mount ,  
parallell



Holder for sleeves of 25 mm in diameter.

## \* Required accessorie for links between step 4 & 5

**601070**  
Joiner M20 Adapter



For mounting of sleeves together with the Joiner Mounting plates.

# 5

## Select end bracket

**601040**  
Joiner Vesa 75



Suitable for installation on most monitors, PCs, tablet PCs, smaller TV or similar. Can also be used for mounting on the instrument panels, floor or ceiling.

**601042**  
Joiner Vesa 75/100



Suitable for installation on most large monitors, PCs, TVs or similar. Can also be used for mounting on the instrument panels, floor or ceiling.

**602100**  
Joiner Beam Mount



Mounted on the side bar in construction vehicles. Adjustable between 55 - 110 mm. M20 adapter is mounted on the bracket.

**602110**  
Joiner Universal Mount



Placed on own selected anchor points. Also fits Volvo F cabin, construction vehicles.

**601060**  
Round Mounting Plate



Hole pattern 2+2+3, for mounting on instrument panels, walls and ceilings.

**601065**  
Round Mounting Plate



Hole pattern 38x38 mm. Plate with threaded holes. Attaches to existing anchor points.

**208000**  
Joiner Chair Rail Mount



Mounted in the passenger chairs left rail. Can also be used in the backseat.

**401713**  
Joiner Wall Mount



For easy lateral movement of the PC/screen.

**601080**  
Joiner Sleeve mount



Pipe holder for sleeve structures 25 mm in diameter.

**601085**  
Joiner Sleeve mount



Fit pipes 15-30 mm in diameter.

**601100**  
Joiner Quicker



Fitted to the windowpane, windshield or other flat surfaces.

**602080**  
Joiner Quick release



Quick release for flexible mountings, where the product quickly be moved, or removed.

**602085**  
Joiner Quick release no plate



Use to quickly and easily remove the bracket. Can also be used with Joiner sleeve.

### Optional mounting adapters for Joiner System

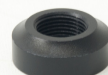

**991010**  
Short Adapter cc28



**991030**  
Cone Puck

#### Technical information

The components of Zirkona Joiner System is powder coated lustreless to reduce reflections.  
Thread size M20x1,5.

# Zirkona Joiner System

## mounting suggestions

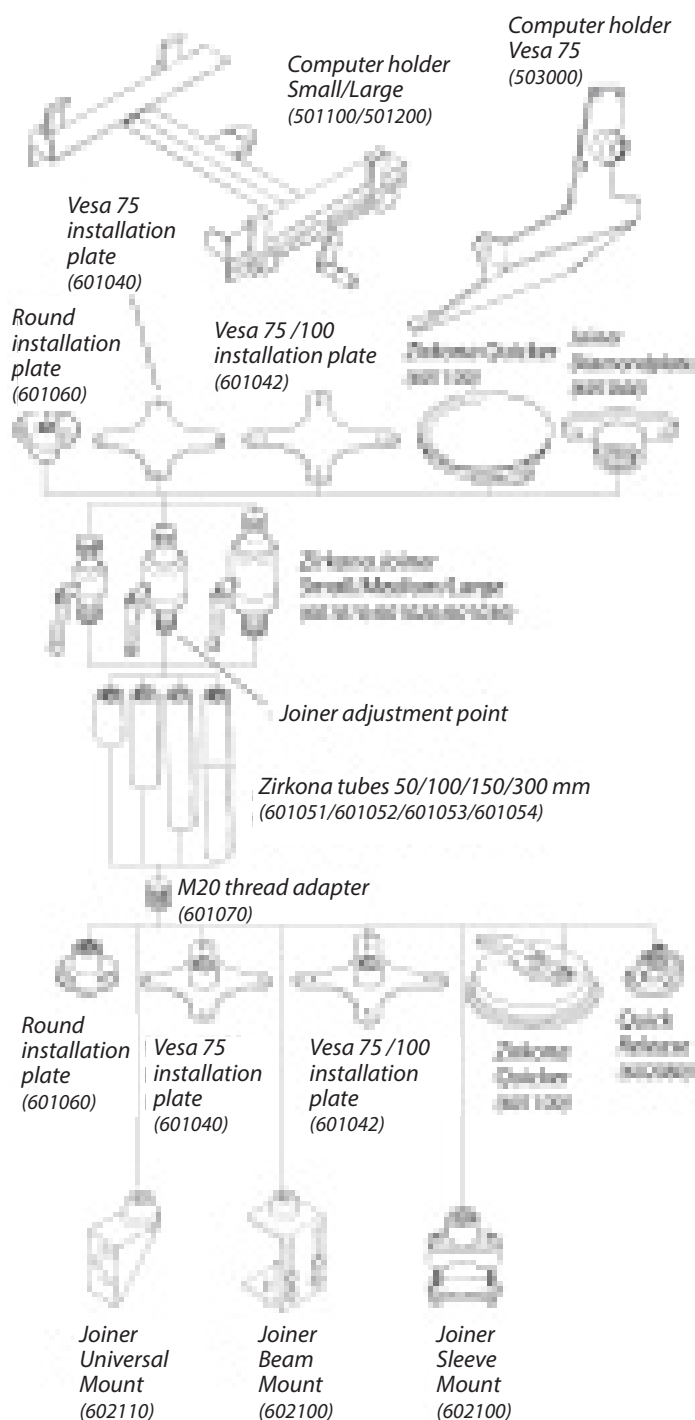

### Zirkona Joiner System

Joiner system provides endless possibilities to compose flexible and stable mounts for screens, laptops, monitors and TVs.

It is the user that determines the end result. It is largely built after your own mind.

Read though our listings below.

**Note!** Clean the mounting surface and Quickers rubber surface with water or glass cleaner. Moisten the rubber surface slightly before installing Quicker. Press the Quicker firmly against the mounting surface and pull down the lever. Remove and re-attach at least once a month.

**Caution!** Do not exceed maximum weight. See the tables below. Measure from Joiner adjustment point.

#### Weight Table (vibrations)

(When mounted where vibrations may occur, eg. vehicles, etc.)

Sleeve length (mm):	0-50	100	150	300
<b>Joiner Small:</b>	2 kg	1,5 kg	1 kg	
<b>Joiner Medium:</b>	4,5 kg	3,5 kg	2,5 kg	1,0 kg
<b>Joiner Large:</b>	6 kg	4,5 kg	3 kg	2 kg

#### Weight table (no vibrations)

(When mounted in a fixed position, eg. TV screens, etc.)

Sleeve length (mm):	0-50	100	150
<b>Joiner Medium:</b>	15 kg	10 kg	8 kg
<b>Joiner Large:</b>	25 kg	15 kg	10 kg

**Caution!** Note that neither Sleeve 300 mm or Joiner Small should be used when mounting the TV screens.

**Warning!** An improperly installed brackets can cause severe damage to both vehicles and people if it is positioned so that it may interfere with the operation of the vehicle.

When the holder is installed in the vehicle, ensure that the mounting surface is a flat, stable surface that can support the weight.

Installation on non-metal surfaces must be made with nuts and bolts only. Use wide washers to protect the surfaces.

### Note!

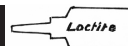

Always apply thread lockers on 20 mm threads. Use Loctite or equivalent.



Unique features  
Endless possibilities



**Zirkona**  
[www.zirkona.com](http://www.zirkona.com)

Reservations for printing errors.  
Zirkona Sweden AB assumes no responsibility for the installation or use of the product.  
All responsibility rests with the user.