

TECHNICAL DATA SHEET
Ref. 530101
 Unipolar BATTERY
 MASTER SWITCH
 24VDC / 150A

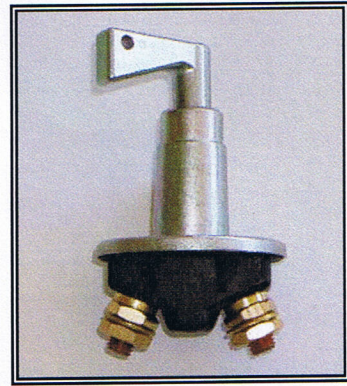

GENERAL CHARACTERISTICS

Protection degree: IP65
 Ambient temperature: -40°C to +85°C
 Weight: 0.24 Kg approx.
 Contacts: Double cut copper
 Connections: not polarized

FIELDS OF APPLICATION

Handling vehicles, industrial vehicles,
 agriculture machinery, industry, navy...

POWER CIRCUIT

Connection: M10 terminals
 Tightening torque: 0.9 +/- 0.1 daN·m
 Type: normally open unipolar
 Max. using tension: 48 V
 Capacity: 150 A in continuous
 450 A during 330 seconds
 1000 A during 5 seconds

PARTICULAR CHARACTERISTICS:

Zinc plated finishing.
 Corrosion test: 200h salt spray resistance
 Abatable Handle

SPARE PARTS

Handle 580019

Connection diagram

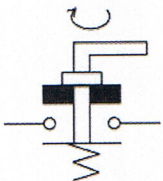

Fixing diagram

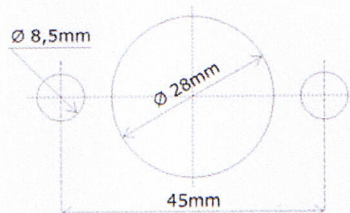

Size diagrams

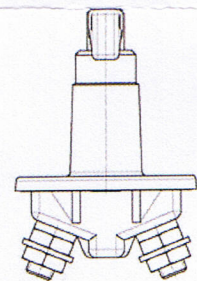
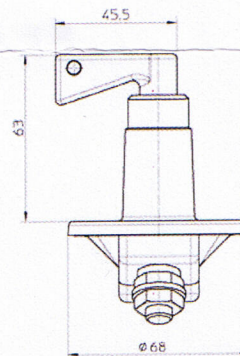

CLOSED

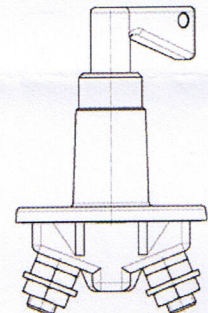
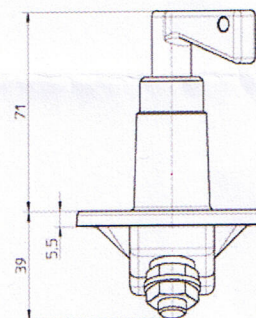
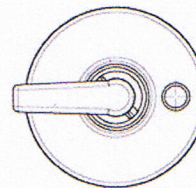

OPEN

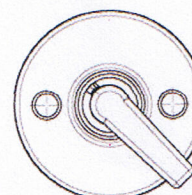

P.I. El RAÍQUER, C/ El RAÍQUER, s/n, NAVE Nº21-22
 08170 MONTORNÈS DEL VALLÈS
 BARCELONA (SPAIN)
 Tel. : + 34.93.544.44.80 - Fax : + 34.93.544.44.90
WWW.CORMAR.ES - info@cormar.es

The assignment and the recommendation of the products inserted in our instructions take account of the state of vehicle stock at the day of their publication. The manufacturer responsibility could not be engaged in case of modification, substitution or suppression of assignments or recommendations which could be occur without advance warning particularly by vehicle manufacturer initiative. The technical characteristics of our products are liable to advance at every time to take account of the technical and technological improvements. No contractual document. Drawing dimensions in millimeters.